

2.4 BOARD LAYOUT

The ACB-2370T is shown in Figure 2-1. This figure shows the location of the controller microcode, BIOS, jumpers, and connectors. Note that Pin 1 of the connectors is identified by a square solder pad on the solder side of the board. The dimensions of the board are:

Width: 3.9 Inches
 Length: 8.0 Inches
 Height: 0.75 Inches

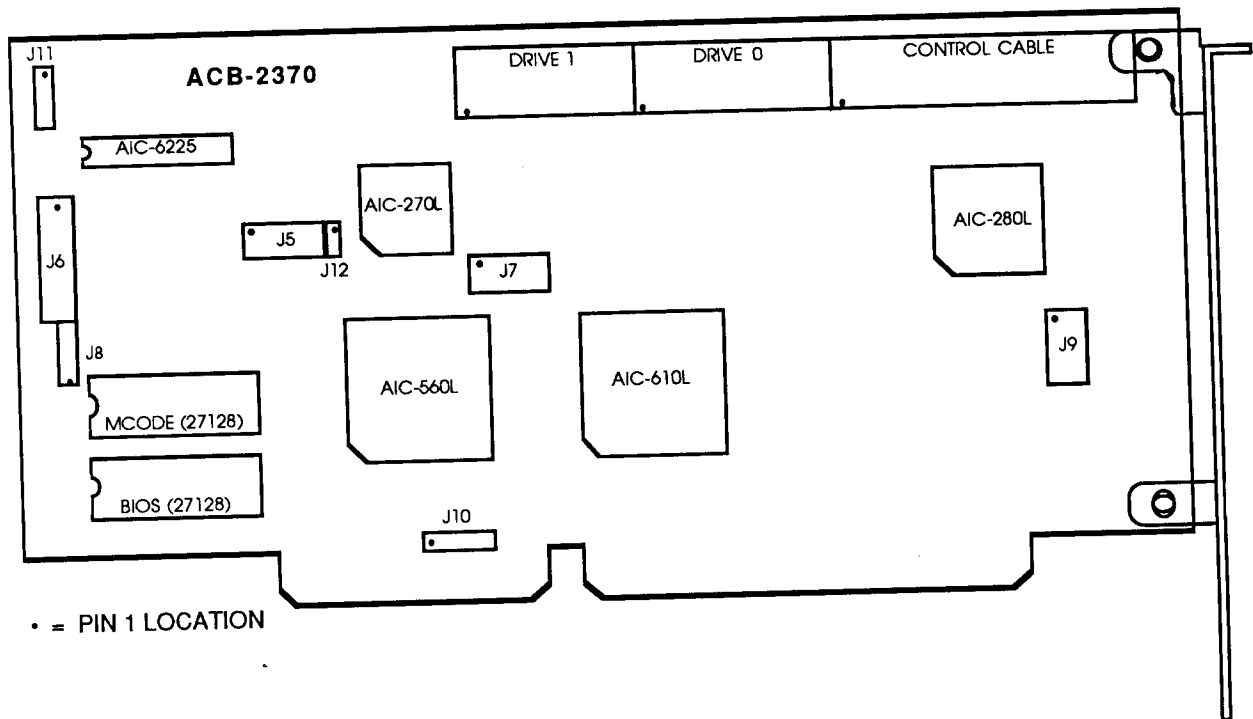

FIGURE 2-1. BOARD LAYOUT

TABLE 2-3. CONTROLLER JUMPER DEFINITIONS

Note: Jumper positions and pin numbers are defined from left to right, or top to bottom, where applicable per Figure 2-1. An asterisk () denotes jumpers that are installed for a standard configuration.*

J1	Hard disk data cable (20 pin), Second drive (Drive 1)
J2	Hard disk data cable (20 pin), First drive (Drive 0)
J3	Hard disk control cable (34 pin), Both drives
J5	MFG TEST POINTS
J6	BOARD CONFIGURATION JUMPERS
	Position 1 Task File Addresses Not installed: primary address 1F0 - 1F7 Installed: secondary address 170 - 177
	Position 2 Not Used
	Position 3 Not Used
	Position 4 Adaptec BIOS utilization Not installed: BIOS in use Installed: BIOS not used. BIOS address jumper J9 must be removed.
	Position 5 Not Used
	Position 6 Not Used
	Position 7 Not Used
	Position 8 Not Used
J7	MFG TEST POINTS
J8	MFG TEST POINTS
J9	Adaptec BIOS address election
	*Position 1 Jumpered for BIOS address C8000 - CBFFF
	Position 2 Not Used
	Position 3 Jumpered for BIOS address CC000 - CFFFF
	Position 4 Not Used
<i>Note: Install only one jumper on J9. No jumper should be installed if BIOS Disabled (J6 position 4 installed).</i>	
J10	Controller's system interrupt selection *Pins 1 and 2 jumpered for IRQ14 Pins 2 and 3 jumpered for IRQ15 Pins 3 and 4 DO NOT USE
J11	LED driver jumper — system drive activity LED connection (<i>Note: J11 is not identified on board. See Figure 2-1 for location.</i>)
J12	*MFG TEST POINT