

Adaptec XHub

Quick Start Guide

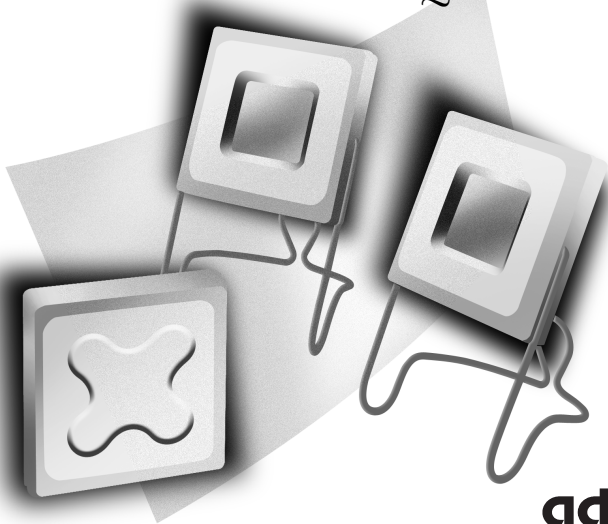

adaptec®

In this Booklet

Introduction	2
What's in the Package	2
This Is Your Hub	3
Plugging in Your Hub	6
Plugging in Your Devices	7
Organizing Your Cables (Plus models only)	8
Stacking Your Hubs	9
Removing the Desk Stand (Plus models only)	12
Personalizing Your Adaptec XHub	13
What's On the CD	14
About USB 2.0 Drivers	14
Technical Specifications	15



Introduction

Congratulations on the purchase of your Adaptec XHub. It has been designed to give you the ultimate in USB expandability and make managing your USB devices easier.

Designed for the way you use a hub, the XHub unit offers easy installation, blazing-fast USB 2.0 speed, and USB 1.1 compatibility. It has easy-access USB ports, a removable desktop stand with build-in cable manager (Plus models only), and an expansion-friendly design that lets you stack multiple hubs together. You can even personalize the Plus models with a photo or your favorite artwork.

This Quick Start Guide shows you how to set up your Adaptec XHub unit and start using it right away.

What's in the Package

The Adaptec XHub package includes:

- Adaptec XHub 4- or 7-port USB 2.0 hub
- USB 2.0-certified cable
- Fully-powered 2.5A (XHub4/4 Plus) or 5A (XHub7 Plus) power adapter
- *XHub Quick Start Guide*
- XHub CD (See [What's On the CD on page 14](#) for more details.)
- Face plate (XHub4) or frame plate (Plus models *only*)
- Desk stand (Plus models *only*)

This Is Your Hub

XHub4 Plus and XHub7 Plus Models

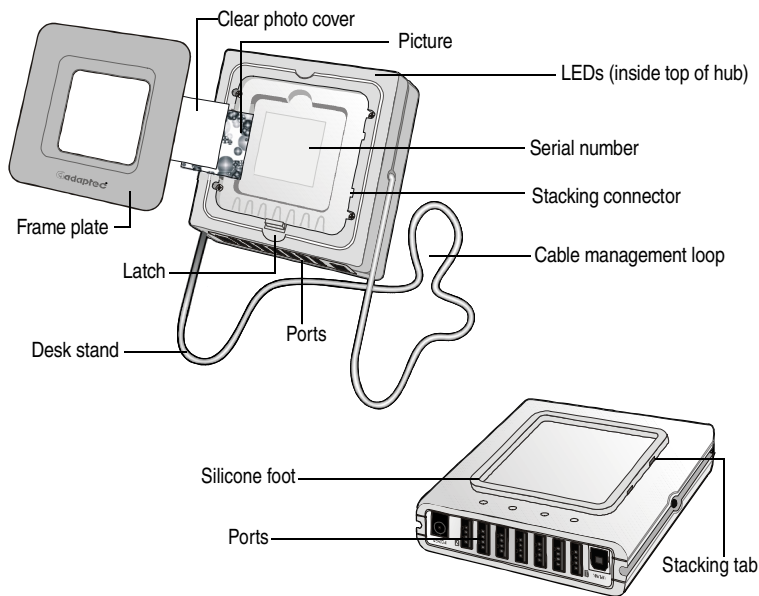

Plus Model
(XHub7 Plus shown here)

XHub4 Model

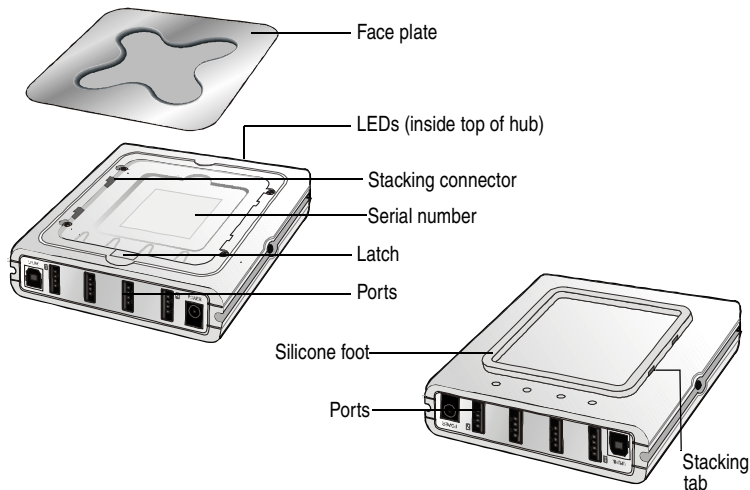

XHub4



Note: The ports correspond to the LEDs. When you plug a device into the hub, the matching LED lights up. (Depending on the device, the LED may light up only when the device is in use.) The Power port has its own LED. See [Port Details on page 5](#) for more information.

Port Details

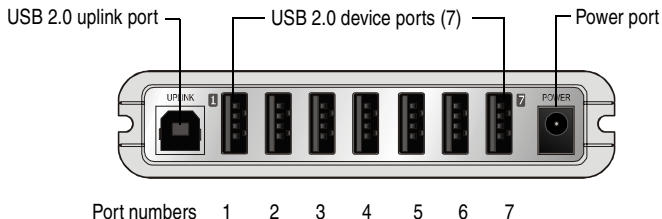

XHub7 Plus Port Details

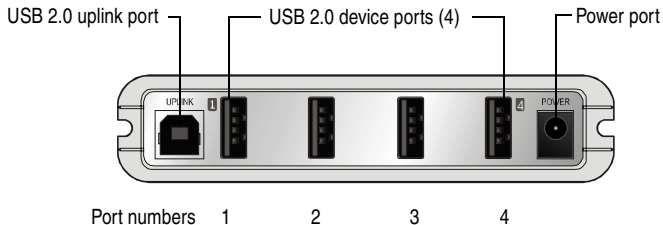

XHub4 / XHub4 Plus Port Details

More information about your XHub is in [Technical Specifications on page 15](#).

Plugging in Your Hub

Follow the picture below to connect your XHub unit to your computer and to a power source.

Start by plugging in the power adapter. The green Power LED at the top of the hub should light up when the power goes on.



Note: Although the Power LED remains lit when the hub is plugged in, the hub enters power-saver mode if there has been no activity on the USB bus for 3 ms.

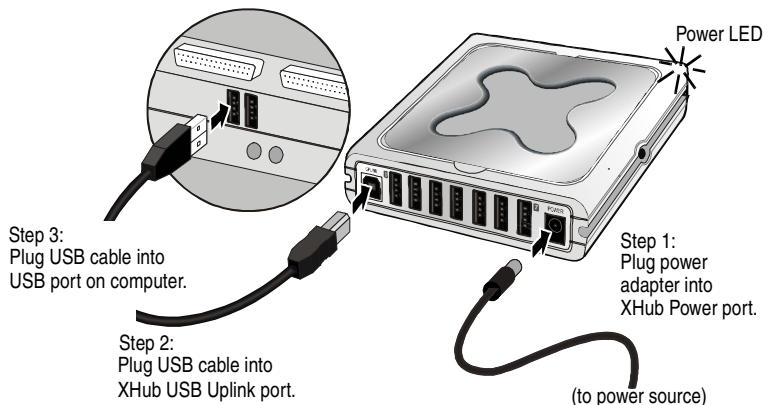

Hub Connections

Plugging in Your Devices

Follow the picture below to connect your USB devices to your XHub unit. You can plug devices into any of the USB ports.

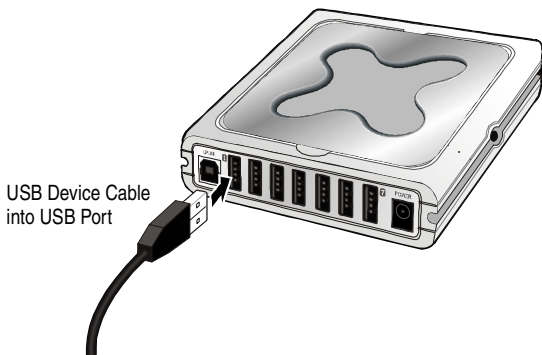

USB Device Connections

Organizing Your Cables (Plus models *only*)

You can use the cable management loop in the desk stand to help you keep your device cables organized. (The picture shows the cable management loop in action.) The cable loop holds up to 14 device cables neatly in place.

Follow the pictures below to organize your cables using the cable management loop.

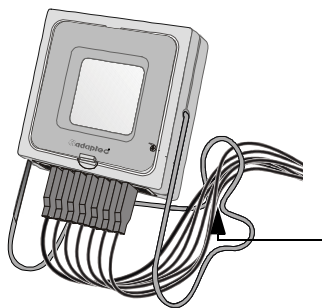

Step 1:
Plug in device cable.

Step 2:
Pull cable up through opening
into the cable management loop.

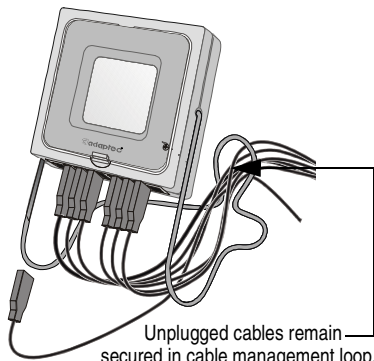

Unplugged cables remain
secured in cable management loop.

Cable Management Using the Desk Stand (Plus models *only*)

Stacking Your Hubs

If you want to add more USB 2.0 ports to your system, Adaptec XHubs can be daisy-chained (linked in series) and stacked together. (See [Making the Most of Your Daisy-Chain on page 11](#) for more information.)

Hubs can be piled on a flat surface (such as your desk) or they can be joined together using the built-in connector slots and tabs.

To join your hubs using the connector slots and tabs:

- 1 Remove the face or frame plate, as shown in the picture below.

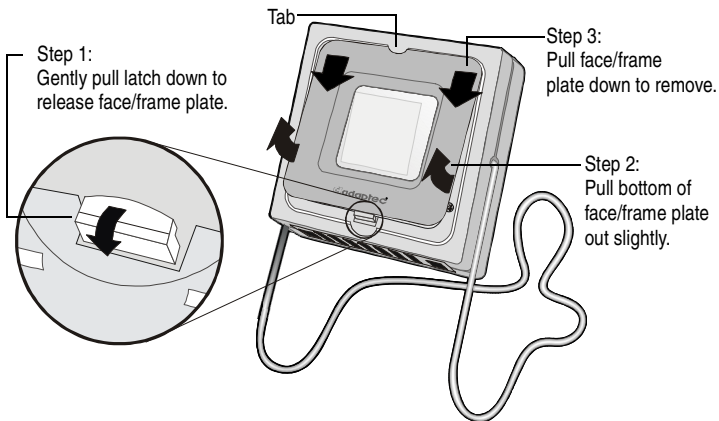

Removing the Face Plate/Frame Plate

- 2 Follow the pictures below to join your hubs together.

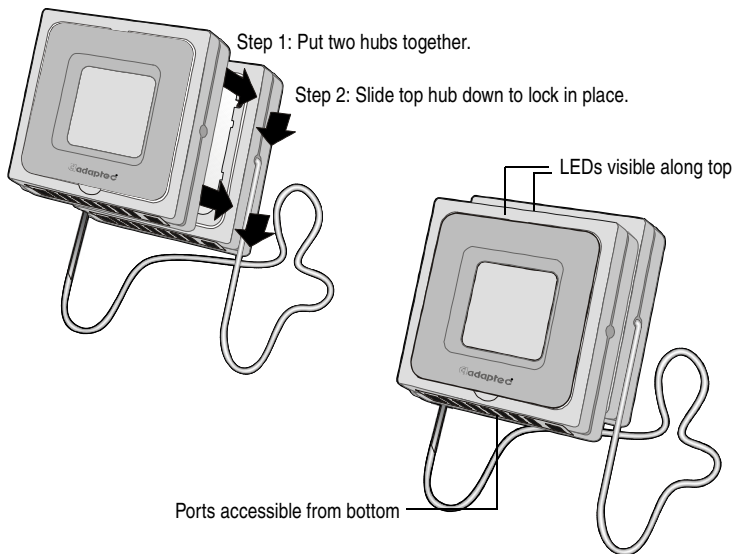

Stacking Hubs on a Desk Stand



Note: Keep gravity in mind: no more than three hubs should be stacked on a desk stand.



Note: To stack your hubs *without* joining them (not pictured), remove the face plates from all but the top hub, and then just pile one hub on top of the other. Align the ports of each hub on one side of the pile for easy access; the LEDs will then be visible on the other side. Then follow Steps 3 and 4 below.

- 3 Connect a power adapter to each hub. (See [Plugging in Your Hub on page 6](#).)
- 4 Connect your hubs to each other using a USB 2.0 cable, following the connection suggestions in the diagram below.

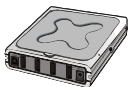

XHub4/XHub4 Plus

Use any USB port to connect to another XHub



XHub7 Plus

For maximum performance, use USB port 1, 3, or 5, especially when stacking more than two hubs.

Making the Most of Your Daisy-Chain

You can connect up to five XHub4s, or up to four XHub7s. The maximum number of hubs on a daisy-chain will vary if you use a combination of XHub4s and XHub7s. (This is a USB limitation.)

Removing the Desk Stand (Plus models *only*)

Follow the picture below to remove your hub from the desk stand.

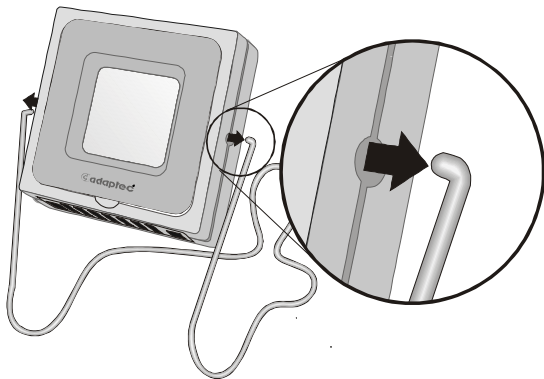

Releasing the Hub from the Desk Stand

To replace the desk stand, pull the sides of the stand slightly apart and carefully fit the hub into place. Avoid scraping the ends of the desk stand across the face/frame plate.

Personalizing Your Adaptec XHub

The following sections explain how to personalize your Adaptec XHub.

Adding a Photo (Plus models *only*)

You can place a photo or your favorite artwork behind the frame plate.

- 1 Remove the frame plate (as shown on [page 9](#)).

The clear plastic photo cover is underneath the frame plate.

- 2 Cut your photo (or other image) to the proper size.

The photo must be 2" by 2" to fit the frame.



Note: You can trace around the photo cover for an exact fit.

- 3 Place your photo in the hub, and place the photo cover over it.
- 4 Replace the frame plate by sliding it under the top tab and then gently pushing the bottom of the frame plate into the hub until the latch snaps closed.

More Customization Options

You can find more customization options at the Adaptec Web site. Go to www.adaptec.com/usb.

What's On the CD

You can find these on your XHub CD:

- Adaptec USB 2.0 drivers (for Windows 98 SE, Me, and 2000.)
- Adaptec USBControl Utility (for Windows 98 SE, Me, 2000, and XP)
- Adobe® Acrobat Reader
- Registration card
- *Adaptec XHub Quick Start Guide*
- ReadMe files

About USB 2.0 Drivers

USB 2.0 driver software with hub support is required for the XHub unit to operate at USB 2.0 speeds. USB 2.0 drivers with hub support can be found on the XHub CD included in your XHub kit.

USB 1.1 devices cannot operate at USB 2.0 speeds even when connected to a USB 2.0 hub or host adapter. USB 2.0 devices, including the XHub unit, connected through a USB 1.1 hub are limited to USB 1.1 speeds. A USB 2.0 hub needs to be connected to a computer or host adapter USB 2.0 port to operate at USB 2.0 speeds. If your computer does not have a built-in USB 2.0 port, we recommend connecting the XHub unit to an Adaptec USB 2.0 card for the highest-quality USB 2.0 connection.

Technical Specifications

Adaptec USB 2 Hi-Speed 4-Port Hub (XHub 4 and XHub 4 Plus)

USB Compliant Version	USB 2.0, USB Hi-Speed Certified
Number of USB Ports	4
Operating Temperature	0 °C – 40 °C
Power Source	Self-powered
Power Adapter Input	AC 100 V – 240 V, 50 Hz/60 Hz
Power Adapter Output	DC 5 V/2.5 A

Adaptec USB 2 Hi-Speed 7-Port Hub (XHub 7 Plus)

USB Compliant Version	USB 2.0, USB Hi-Speed Certified
Number of USB Ports	7
Operating Temperature	0 °C – 40 °C
Power Source	Self-powered
Power Adapter Input	AC 100 V – 240 V, 50 Hz/60 Hz
Power Adapter Output	DC 5 V/5 A

Copyright

© 2001 Adaptec, Inc. All rights reserved. No part of this publication may be reproduced, stored in a retrieval system, or transmitted in any form or by any means, electronic, mechanical, photocopying, recording or otherwise, without the prior written consent of Adaptec, Inc., 691 South Milpitas Blvd., Milpitas, CA 95035.

Trademarks

Adaptec, XHub, and the Adaptec logo are trademarks of Adaptec, Inc., which may be registered in some jurisdictions.

Microsoft, Windows 98SE, Windows Me, and Windows 2000 are registered trademarks of Microsoft Corporation in the U.S. and other countries used under license.

Macintosh is a registered trademark of Apple Computer, Inc. used under license.

All other trademarks are the property of their respective owners.

Changes

The material in this document is for information only and is subject to change without notice. While reasonable efforts have been made in the preparation of this document to assure its accuracy, Adaptec, Inc. assumes no liability resulting from errors or omissions in this document, or from the use of the information contained herein.

Adaptec reserves the right to make changes in the product design without reservation and without notification to its users.

Disclaimer

IF THIS PRODUCT DIRECTS YOU TO COPY MATERIALS, YOU MUST HAVE PERMISSION FROM THE COPYRIGHT OWNER OF THE MATERIALS TO AVOID VIOLATING THE LAW WHICH COULD RESULT IN DAMAGES OR OTHER REMEDIES.

Adaptec Customer Support

If you have questions about installing or using your Adaptec product, check this document first—you will find answers to most of your questions here. If you need further assistance, use the support options listed below.

Technical Support Identification (TSID) Number

- Before contacting Technical Support, you'll need your TSID. The TSID helps us provide more efficient service by accurately identifying your product and support status. The 12-digit TSID can be found on the white barcode-type label included inside the box with your product.
- Affix your TSID label on the jacket of the CD included in your kit

Support Options

- Search the Adaptec Support Knowledgebase (ASK) at <http://ask.adaptec.com> for articles, troubleshooting tips, and frequently asked questions for your product.
- For support via Email, submit your question to Adaptec's Technical Support Specialists at <http://ask.adaptec.com>.

North America

- Visit our Web site at <http://www.adaptec.com>.
- For information about Adaptec's support options, call +1 408-957-2550, 24 hours per day, 7 days per week.
- To speak with a Technical Support Specialist,

Call +1 408-934-7274,
Monday–Friday, 3:00 a.m. to 5:00 p.m., Pacific Time.

To expedite your service, have your XHub unit in front of you.

- To order Adaptec products, including accessories and cables, call +1 408-957-7274.

Europe

- Visit our Web site at <http://www.adaptec-europe.com>.
- **English and French:** To speak with a Technical Support Specialist, call one of the following numbers, Monday to Thursday, 10:00 to 12:30 and 13:30 to 17:30; Friday, 10:00 to 12:30 and 13:30 to 16:30, Central European Time:
 - **English:** +32 2 352 3470
 - **French:** +32 2 352 3460

To expedite your service, have your computer in front of you.

- **German:** To speak with a Technical Support Specialist, call +49 89 456 40660, Monday to Thursday, 9:30 to 12:30 and 13:30 to 16:30; Friday, 9:30 to 12:30 and 13:30 to 15:00, Central European Time. To expedite your service, have your computer in front of you.
- To order Adaptec products, including accessories and cables, call +32 11 300 379.

Australia and New Zealand

- Visit our Web site at <http://www.adaptec.com.au>.
- To speak with a Technical Support Specialist, call +612 9416 0698, Monday to Friday, 10:00 A.M. to 4:30 P.M., Eastern Australia Time. To expedite your service, have your computer in front of you.

Hong Kong and China

- Visit our Web site at <http://www.adaptec.com>.
- To speak with a Technical Support Specialist, call +852 2869 7200, Monday to Friday, 10:00 A.M. to 5:00 P.M. To expedite your service, have your computer in front of you.
- Fax Technical Support at +852 2869 7100.

Singapore

- Visit our Web site at <http://www.adaptec.com>.
- To speak with a Technical Support Specialist, call +65 245 7470, Monday to Friday, 10:00 A.M. to 5:00 P.M. To expedite your service, have your computer in front of you.

Japan

- Visit our Web site at <http://www.adaptec.co.jp>.
- To speak with a Technical Support Specialist, call +81 3 5308 6120 Monday–Friday, 9:00 A.M. to 12:00 P.M and 1:00 P.M. to 6:00 P.M.

Limited 1-Year Hardware Warranty

1. Adaptec, Inc. ("Adaptec") warrants to the purchaser of this product that it will be free from defects in material and workmanship for a period of one (1) year from the date of purchase. If the product should become defective within the warranty period, Adaptec, at its option, will repair or replace the product, or refund the purchaser's purchase price for the product, provided it is delivered at the purchaser's expense to an authorized Adaptec service facility or to Adaptec.
2. Repair or replacement parts or products will be furnished on an exchange basis and will either be new or reconditioned. All replaced parts or products shall become the property of Adaptec. This warranty shall not apply if the product has been damaged by accident, misuse, abuse or as a result of unauthorized service or parts.
3. Warranty service is available to the purchaser by delivering the product during the warranty period to an authorized Adaptec service facility or to Adaptec and providing proof of purchase price and date. The purchaser shall bear all shipping, packing and insurance costs and all other costs, excluding labor and parts, necessary to effectuate repair, replacement or refund under this warranty.
4. For more information on how to obtain warranty service, write or telephone Adaptec at 691 South Milpitas Boulevard, Milpitas, CA 95035, (800) 959-7274.
5. THIS LIMITED WARRANTY DOES NOT EXTEND TO ANY PRODUCT WHICH HAS BEEN DAMAGED AS A RESULT OF ACCIDENT, MISUSE, ABUSE, OR AS A RESULT OF UNAUTHORIZED SERVICE OR PARTS.

6. THIS WARRANTY IS IN LIEU OF ALL OTHER EXPRESS WARRANTIES WHICH NOW OR HEREAFTER MIGHT OTHERWISE ARISE RESPECT TO THIS PRODUCT. IMPLIED WARRANTIES, INCLUDING THOSE OF MERCHANTABILITY, FITNESS FOR A PARTICULAR PURPOSE AND NON-INFRINGEMENT SHALL (A) HAVE NO GREATER DURATION THAN 1 YEAR FROM THE DATE OF PURCHASE, (B) TERMINATE AUTOMATICALLY AT THE EXPIRATION OF SUCH PERIOD AND (C) TO THE EXTENT PERMITTED BY LAW BE EXCLUDED. IN THE EVENT THIS PRODUCT BECOMES DEFECTIVE DURING THE WARRANTY PERIOD, THE PURCHASER'S EXCLUSIVE REMEDY SHALL BE REPAIR, REPLACEMENT OR REFUND AS PROVIDED ABOVE. INCIDENTAL OR CONSEQUENTIAL DAMAGES, INCLUDING WITHOUT LIMITATION LOSS OF DATA, ARISING FROM BREACH OF ANY EXPRESS OR IMPLIED WARRANTY ARE NOT THE RESPONSIBILITY OF ADAPTEC AND, TO THE EXTENT PERMITTED BY LAW, ARE HEREBY EXCLUDED BOTH FOR PROPERTY DAMAGE, AND TO THE EXTENT NOT UNCONSCIONABLE, FOR PERSONAL INJURY DAMAGE.
7. SOME STATES DO NOT ALLOW THE EXCLUSION OR LIMITATION OF INCIDENTAL OR CONSEQUENTIAL DAMAGES FOR CONSUMER PRODUCTS, AND SOME STATES DO NOT ALLOW LIMITATIONS ON HOW LONG AN IMPLIED WARRANTY LASTS, SO THE ABOVE LIMITATION OR EXCLUSIONS MAY NOT APPLY TO YOU.
8. This warranty gives you specific legal rights, and you may also have other rights which vary from state to state.

Adaptec Software License Agreement

PLEASE READ CAREFULLY: THE USE OF THIS SOFTWARE IS SUBJECT TO THE SOFTWARE LICENSE TERMS OF ADAPTEC, INC. AND OTHER LICENSORS WHOSE SOFTWARE MAY BE BUNDLED WITH THIS PRODUCT.

BY YOUR USE OF THE SOFTWARE INCLUDED WITH THIS PRODUCT YOU AGREE TO THE LICENSE TERMS REQUIRED BY THE LICENSOR OF THAT SOFTWARE, AS SET FORTH DURING THE INSTALLATION PROCESS. IF YOU DO NOT AGREE TO THE LICENSE TERMS APPLICABLE TO THE SOFTWARE, YOU MAY RETURN THE ENTIRE UNUSED PRODUCT FOR A FULL REFUND.

In return for acquiring a license to use the Adaptec software, which may include software from third party licensors and patches made available by Adaptec ("Software"), and the related documentation, you agree to the following terms and conditions:

1. License. This Agreement grants you, the Licensee, a license to:
 - a. Use the Software on a single computer system, which is not intended for use by more than five (5) users; and:
 - b. Make one copy of the Software in machine readable form solely for back-up purposes, provided you reproduce Adaptec's copyright proprietary legends. Notwithstanding the foregoing, the Software may be used on the home, laptop or other secondary computer of the principal user of the Software, and an additional copy of the Software may be made to support such use. As used in this license, the Software is "in use" when it is either loaded into RAM or installed on a hard disk or other permanent memory device. The Software may be "in use" on only one computer at any given time. (Different license terms and fees are applicable for networked or multiple user applications.) As a specific condition of this license, you agree to use the Software in compliance with all applicable laws, including copyright laws, and that you will not copy, transmit, perform or distribute any audio or other content using the Software without obtaining all necessary licenses or permissions from the owner of the content.
2. Restrictions. You may not distribute copies of the Software to others or electronically transfer the Software from one computer to another over a network. You may not post or otherwise make available the Software, or any portion thereof, in any form, on the Internet. You may not use the Software in a computer service business, including in time sharing applications. The Software contains trade secrets and, in order to protect them, you may not decompile, reverse engineer, disassemble, or otherwise reduce the Software

to a human-perceivable form. YOU MAY NOT MODIFY, ADAPT, TRANSLATE, RENT, LEASE, LOAN, RESELL FOR PROFIT, DISTRIBUTE, NETWORK OR CREATE DERIVATIVE WORKS BASED UPON THE SOFTWARE OR ANY PART THEREOF.

3. Ownership of Software. As Licensee, you own the media upon which the software is recorded or fixed, but Adaptec and its licensors retain title and ownership of the Software recorded on the original media and all subsequent copies of the Software, regardless of the form or media in which or on which the original and other copies may exist. This license is not a sale of the Software or any copy.
4. Confidentiality. You agree to maintain the Software in confidence and that you will not disclose the Software to any third party without the express written consent of Adaptec. You further agree to take all reasonable precautions to preclude access of unauthorized persons to the Software.
5. Term. This license is effective until January 1, 2045, unless terminated earlier. You may terminate the license at any time by destroying the Software (including the related documentation) together with all copies or modifications in any form. Adaptec will have the right to terminate our license immediately if you fail to comply with any term or condition of this Agreement. Upon any termination, including termination by you, you must destroy the Software (including the related documentation), together with all copies or modifications in any form.
6. Special Terms Applicable to Databases. Where a database is included with the Software, you acknowledge that it is licensed only in connection with the use of the Software to perform disc creation, and that the database and all data derived therefrom must be maintained in confidence in accordance with the provisions of Section 4. This license does not grant you any rights to distribute or disclose such database or data.
7. Limited Warranty. Adaptec and its Licensor warrant only that the media upon which the Software is furnished will be free from defects in material or workmanship under normal use and service for a period of thirty (30) days from the date of delivery to you. ADAPTEC AND ITS LICENSORS DO NOT AND CANNOT WARRANT THE PERFORMANCE OR RESULTS YOU MAY OBTAIN BY USING THE SOFTWARE OR DOCUMENTATION. THE FOREGOING STATES THE SOLE AND EXCLUSIVE REMEDIES ADAPTEC AND ITS LICENSORS WILL PROVIDE FOR BREACH OF WARRANTY. EXCEPT FOR THE FOREGOING LIMITED WARRANTY, ADAPTEC AND ITS LICENSORS MAKE NO WARRANTIES, EXPRESSED OR IMPLIED, INCLUDING, BUT NOT LIMITED, AS TO NON-INFRINGEMENT OF THIRD PARTY RIGHTS,

MERCHANTABILITY OR FITNESS FOR A PARTICULAR PURPOSE. Some states do not allow the exclusion of implied warranties or limitations on how long an implied warranty may last, so the above limitations may not apply to you. This warranty gives you specific legal rights and you may also have other rights which vary from state to state.

8. The entire liability of Adaptec and its licensors, and your exclusive remedy for a breach of this warranty, shall be:
 - a. The replacement of any media not meeting the above limited warranty which is returned to Adaptec; or:
 - b. if Adaptec or its distributor is unable to deliver replacement media which is free from defects in materials or workmanship, you may terminate this Agreement by returning the Software and your money will be refunded.
9. Limitation of Liability. IN NO EVENT WILL ADAPTEC OR ITS LICENSORS BE LIABLE TO YOU FOR ANY INCIDENTAL, CONSEQUENTIAL OR INDIRECT DAMAGES, INCLUDING ANY LOST PROFITS, LOST SAVINGS, OR LOSS OF DATA, EVEN IF ADAPTEC OR A LICENSOR HAS BEEN ADVISED OF THE POSSIBILITY OF SUCH DAMAGES, OR FOR ANY CLAIM BY ANY OTHER PARTY. Some states do not allow the exclusion or limitation of special, incidental, or consequential damages, so the above limitation or exclusion may not apply to you.
10. Export. You acknowledge that the laws and regulations of the United States and other countries may restrict the export and re-export of the Software. You agree that you will not export or re-export the Software or documentation in any form in violation of applicable United States and foreign law.
11. Government Restricted Rights. The Software is subject to restricted rights as follows. If the Software is acquired under the terms of a GSA contract: use, reproduction or disclosure is subject to the restrictions set forth in the applicable ADP Schedule contract. If the Software is acquired under the terms of a DoD or civilian agency contract, use, duplication or disclosure by the Government is subject to the restrictions of this Agreement in accordance with 48 C.F.R. 12.212 of the Federal Acquisition Regulations and its successors and 49 C.F.R. 227.7202-1 of the DoD FAR Supplement and its successors.
12. General. You acknowledge that you have read this Agreement, understand it, and that by using the Software you agree to be bound by its terms and conditions. You further agree that it is the complete and exclusive statement of the agreement between Adaptec and

you, and supersedes any proposal or prior agreement, oral or written, and any other communication between Adaptec and you relating to the subject matter of this Agreement. No additional or any different terms will be enforceable against Adaptec unless Adaptec gives its express consent, including an express waiver of the terms of this Agreement, in writing signed by an officer of Adaptec. You assume full responsibility for the use of the Software and agree to use the Software legally and responsibly. This Agreement shall be governed by California law, except as to copyright matters, which are covered by Federal law. This Agreement is deemed entered into at Milpitas, California by both parties. Should any provision of this Agreement be declared unenforceable in any jurisdiction, then such provision shall be deemed severable from this Agreement and shall not affect the remainder hereof. All rights in the Software not specifically granted in this Agreement are reserved by Adaptec.

Should you have any questions concerning this Agreement, you may contact Adaptec by writing to:

Adaptec, Inc.
Legal Department
691 South Milpitas Boulevard
Milpitas, California 95035

Regulatory Compliance Statements

Federal Communications Commission Radio Frequency Interference Statement

WARNING: Changes or modifications to this unit not expressly approved by the party responsible for compliance could void the user's authority to operate the equipment.

This equipment has been tested and found to comply with the limits for a Class B digital device, pursuant to Part 15 of the FCC rules. These limits are designed to provide reasonable protection against harmful interference in a residential installation. This equipment generates, uses, and can radiate radio frequency energy, and if not installed and used in accordance with the instruction manual, may cause harmful interference to radio communications. However, there is no guarantee that interference will not occur in a particular installation. However, if this equipment does cause interference to radio or television equipment reception, which can be determined by turning the equipment off and on, the user is encouraged to try to correct the interference by one or more of the following measures:

- Reorient or relocate the receiving antenna.
- Increase the separation between equipment and receiver.
- Connect the equipment to an outlet on a circuit different from that to which the receiver is connected.
- Consult the dealer or an experienced radio/television technician for help.
- Use a shielded and properly grounded I/O cable and power cable to ensure compliance of this unit to the specified limits of the rules.

This device complies with part 15 of the FCC rules. Operation is subject to the following two conditions: (1) this device may not cause harmful interference and (2) this device must accept any interference received, including interference that may cause undesired operation.

Adaptec, Inc.

XHub 4/XHub 4+/XHub 7+



Tested to Comply
With FCC Standards

FOR HOME OR OFFICE USE



European Union Compliance Statement

This Information Technology Equipment has been tested and found to comply with the following European directives:

EMC Directive 89/336/EEC, as amended by 92/31/EEC and 93/68/EEC

EN50081-1 (1992)

EN55022 (1994) Class B

EN50082-1 (1992)

EN61000-4-2 (1998)

EN61000-4-3 (1998)

EN61000-4-4 (1995)

EN61000-4-5 (1995) Surges

EN61000-4-6 (1996) Conducted immunity

EN61000-4-11 (1994) Supply dips of variation



Australian/New Zealand Compliance Statement

This device has been tested and found to comply with the limits for a Class B digital device, pursuant to the Australian/New Zealand standard AS/NZS 3548 set out by the Spectrum Management Agency.



Canadian Compliance Statement

This Class B digital apparatus meets all requirements of the Canadian Interference-Causing Equipment Regulations.

Cet appareil numérique de la classe B respecte toutes les exigences du Règlement sur le matériel brouilleur du Canada.



Japanese Compliance (Voluntary Control Council Initiative)



Adaptec, Inc.

691 South Milpitas Boulevard
Milpitas, CA 95035 USA

© 2001 Adaptec, Inc.

All rights reserved. Adaptec and the Adaptec logo
are trademarks of Adaptec, Inc. which may be
registered in some jurisdictions.

Part Number: 512964-06, Ver. AB LW 10/01